

SH 8 A Sensor Holder

- For cylindrical Sensors of $\varnothing 8$ mm or thread M8
- Simple installation
- Reduced mounting/downtimes thanks to one-piece construction
- Sensor exchange without changing the clamp position
- Limit stop for sensor exchange without readjustment
- Oblong holes permit clamp adjustment

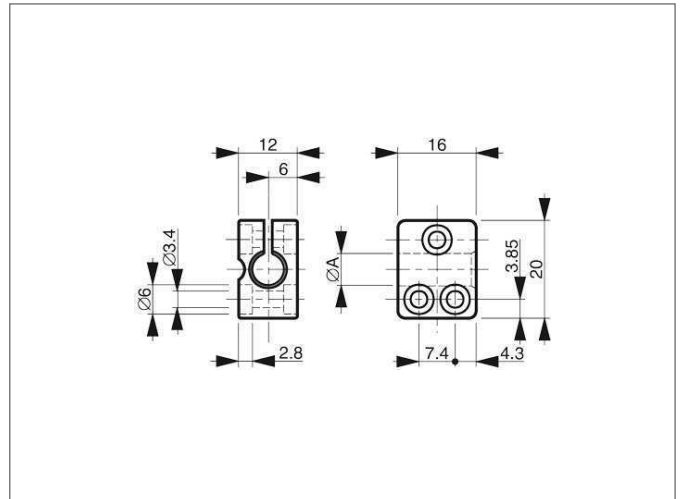

TECHNICAL INFORMATION (typ.)

Size

+20°C, 24V DC

8,0 mm (Clamping diameter A)

Characteristics

with limit stop

Casing material

plastics (polyamide - PA 6 GK)